

TRIM-TEX

Reveal Corner Bead Installation Instructions

Product Overview

Trim-Tex Reveal Corner Bead is designed to add a reveal detail to a 90° outside corner. Can be used with 1/2" and 5/8" drywall.

Installation Instructions

1. Set back your drywall as shown in **Figure A**. Cut the bead to length and dry fit it into place to ensure an accurate installation.

2. For ultimate bond, spray a coat of 847 on the mud legs and the drywall. For single surface application, apply two medium coats to the drywall or the mud legs.

3. Install bead immediately and pressure the mud legs to the drywall. If the adhesive dries and there is no tack to it, apply additional coats of spray adhesive.

4. Once in position, use the Trim-Tex Installation Tool or the handle of your taping knife to pressure the mud leg and the tabs to the drywall. (A FREE tool is included with every purchase of 847 Spray Adhesive.) Staple the mud legs every 6"-8" with 1/2" staples.

5. Mud as usual. Be sure to use All-Purpose or Multi-Purpose Compound. Add Mud-Max to your drywall compound for the ultimate performance. Prime and paint as usual.

Quick Tip

Use a miter saw to create miter cuts for 3 way and 2 way intersections, as shown in **Figure B**.

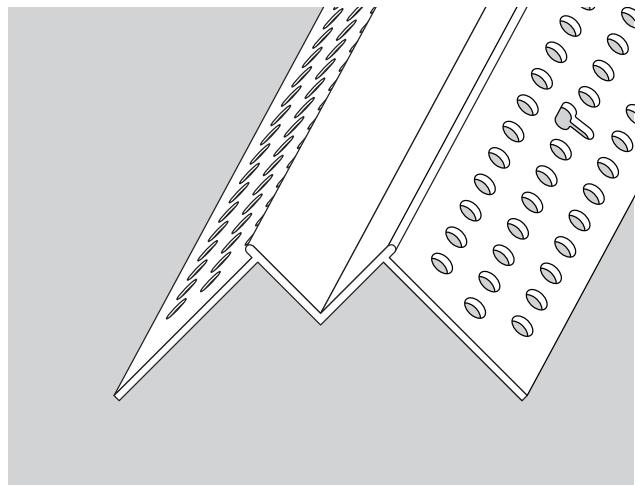

STOCK NUMBER	LENGTH	PCS PER BOX
9910	10'	30

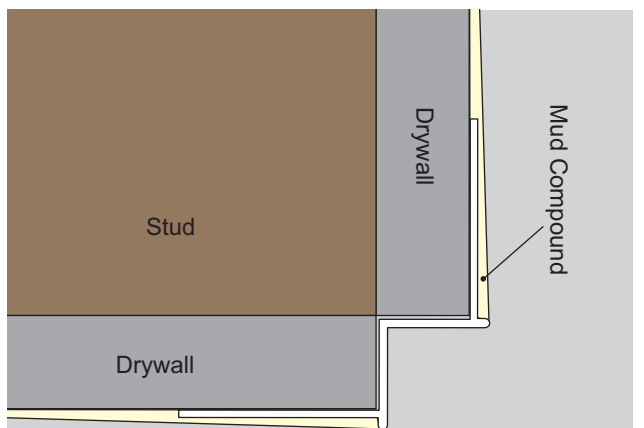

Figure A Set Back Drywall as Shown



Figure B



Stay Connected



www.trim-tex.com • 1-800-874-2333